

### 1. Removal of Nexion Furniture

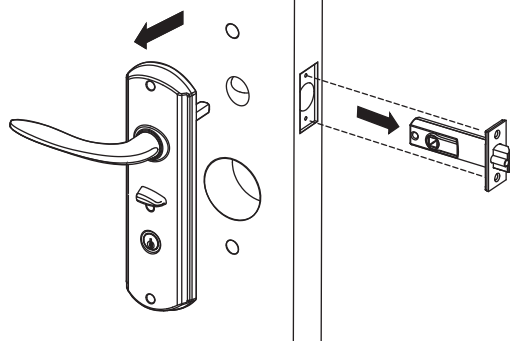

- Take off your internal and external Nexion Furniture and latch as shown above.

### 2. Removal of Nexion Strike

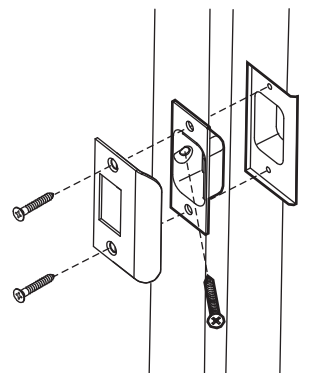

- Remove your Nexion Strike plate from door jamb as shown above.

### 3. Unity Entrance Lock door preparation

Existing Nexion door preparation with Unity template.

Line up the template with the Ø54mm hole at the bottom.

When performing a retrofit install, there is no need to drill the Ø12.5mm hole for the DPS.

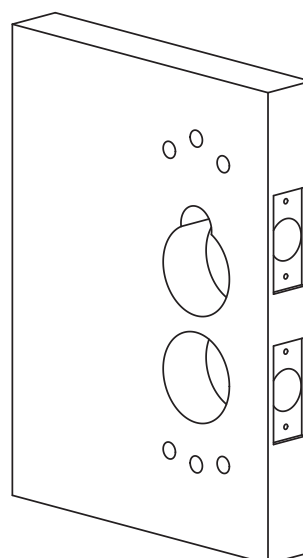
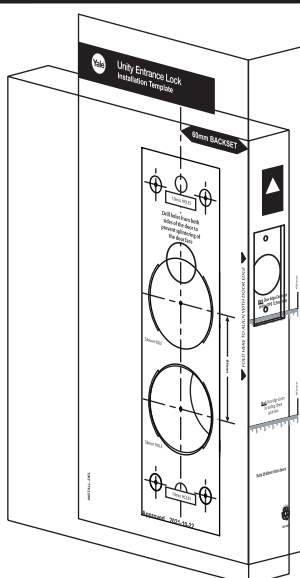

Nexion with added Unity door preparation

- Use the Unity Entrance lock installation template to prepare the door as shown above, which includes 2 by Ø54mm holes and 4 by Ø10mm holes.

### 4. Install the Yale Unity entrance lock

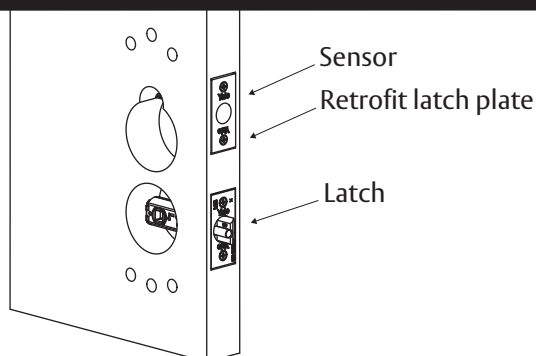

- Install the Yale Unity entrance lock latch at bottom hole and retrofit latch plate to cover the old Nexion latch hole.
- Install door position sensor as shown above.

### 5. Install door position magnet & strike

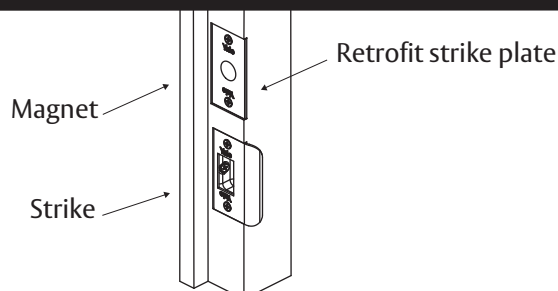

- Select the retrofit strike plate based on the thickness of the door jamb and fit the door position magnet.
- Fit the Yale Entrance lock strike plate into position as shown above.

