

MC240R

Yale

Styleline 2 Window handle



- 1 x Styleline 2 left-handed window handle
- 2 x Screws
- 1 x Installation instructions

Tools required

- Drill
- 3.5mm drill bit
- #1 square screwdriver
- Marker pen
- Safety goggles



Suitable for awning windows



Suitable for casement windows



Easy install



Instructions included

ASSA ABLOY New Zealand
6 Armstrong Road, Albany,
Auckland 0632, New Zealand
Quality, ISO 9001
Environmental, ISO 14001
For customer feedback:
nzsales@assaabloy.com
yalehome.com/nz

MC240R
025110_0323



9 1414553 064012



PLEASE
RECYCLE
Part of ASSA ABLOY



SUITABLE
FOR AWNING



SUITABLE
FOR CASEMENT





Slimline 2 Window Handle

Fixing Instructions

A Installing Face Fix Base and Sub Fix Base

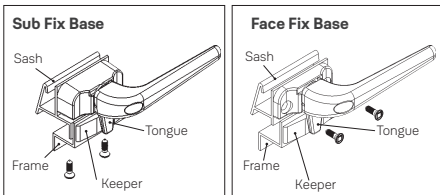

- 1A **Remove existing handle** by unscrewing fixing screws or drilling out the head of the rivets if used
- 2A **Fitting face fix and sub fix handles.** If the handle base has exactly the same hole centres, simply re-fit the new handle with screws provided. For sub fix base, refer to handy hints Note: Rivets can be used if preferred
- 5A **Test operation** of handle and ensure that the tongue holds the window sash firmly against frame. This will ensure that the window is sealed

Installation Notes

- Ensure the location of the holes in the handle base matches your existing handle
- Before drilling any new holes check the OFFSET* to ensure correct replacement handle selection
- Replacement keepers are available in different thicknesses through your locksmith or hardware retailer
- The "marking gauge" should not be used as a drilling guide as plastic material will allow the drill to wander

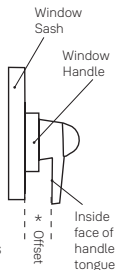

B Replacing Vertical Fix Handle - Using Sub Fix Base

- 1B Remove plastic screw cover to expose existing fixing screws and remove handle

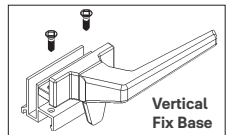

- 2B Locate the conical points of the "marking gauge" provided in the existing holes ensuring that the arrows point to the glass. Mark the position for the new holes through the holes in the "marking gauge". Centre punch the new hole positions before drilling using a 3.5mm drill

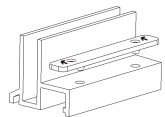

Note: If the conical points of the "marking gauge" do not align with the existing screw holes, check the offset before drilling to determine correct hole centres

- 3B Fit vertical fix packer to back of the sub fix handle base cavity. Fit new handle with screws provided, refer to handy hints

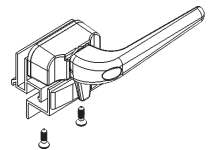

- 4B Test operation of handle and ensure that the tongue holds the window sash firmly against the frame. This will ensure that the window is sealed

Handy Hints



The screw holes in sub fix handle mounting plates are not pre threaded and the screws provided are "thread cutting". To make installation easier, place the handle on a soft surface and apply a drop of oil or lubricant to the screw thread and drive the screw in and out to pre-cut the thread prior to installation.

10
YEAR
WARRANTY

The warranty covers manufacturing defects, standard finishes but excludes plated finishes or finishes exposed to a corrosive environment. The warranty excludes damage caused by installation contrary to written instructions and incidental or consequential damage. We recommend regular cleaning with mild detergent.