



LEVER LOCKSET

INSTALLATION INSTRUCTIONS FOR ENTRANCE, PRIVACY & PASSAGE LOCKSETS
FOR USE ON DOORS 35mm TO 45mm THICK

1. PREPARE DOOR

- Fold and position template at the desired height for the lockset. Mark latch hole position as shown.

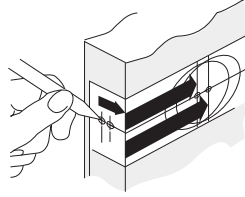

- Mark the centre point of the lockset hole on the door face at the desired backset, either 60mm or 70mm.

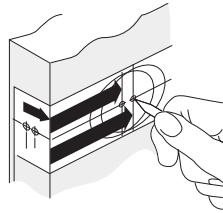

2. DRILL HOLES

- Using a 54mm hole saw, drill through face of door. It is recommended that holes be drilled from both sides to prevent splitting.

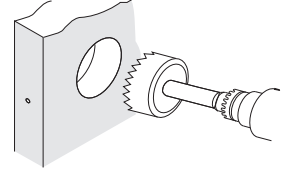

- Drill a 25mm hole in the centre of the door edge through to 54mm hole.

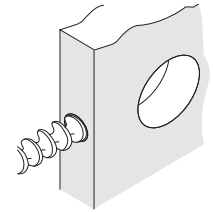

3. PREPARE LATCH

- To extend latch to 70mm backset, slide spindle hub in direction shown.

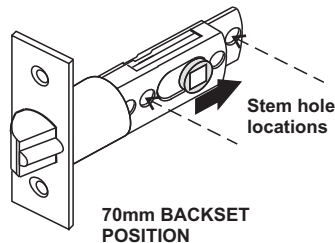
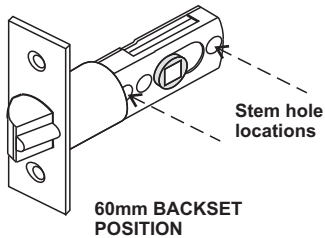

4. INSTALL LATCH

- A.** Insert latch in hole. Keeping it parallel to door face, mark outline of latch face and screw holes. Remove latch.

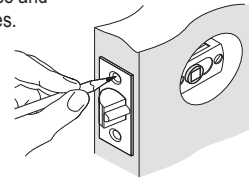

- B.** Chisel a 3mm deep rebate or until the latch face is flush with the door edge.

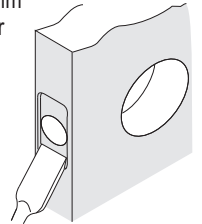

- C.** Insert latch and tighten screws.

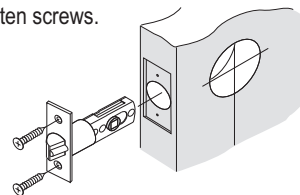

P/No. YL-121 Iss. A 1209



THIS WAY UP

FOLD HERE

READ INSTRUCTIONS
45mm THICK
DOOR



35mm
THICK
DOOR

60mm BACKSET

54mm Hole

70mm BACKSET

TEMPLATE

5. INSTALL STRIKE

- With the latch inserted into door, close the door and mark the position of the strike on the door jamb and the centre position of the latch.

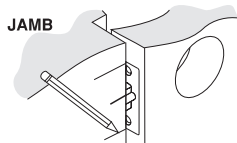

- Bore a 25mm hole to a depth of 25mm at the centre position of the latch.

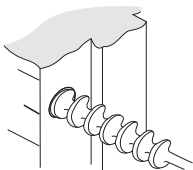

- Position Strike on door jamb at the positions marked. Scribe around strike and chisel out rebate to a depth of 2mm.

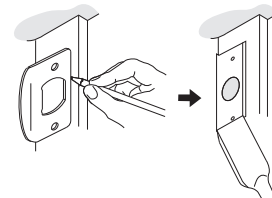

- Secure strike to door with two wood screws provided. To prevent loose fit of the latch and the strike, bend small tab in strike.

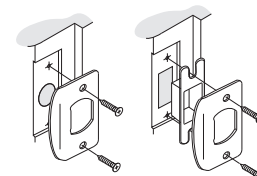

6. INSTALL EXTERIOR MECHANISM

- Insert exterior lever with spindle into latch making certain that the stems are positioned correctly through the latch holes. Press flush against the door.

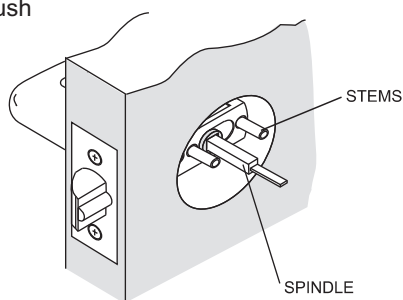

7. INSTALL INTERIOR MECHANISM

- Turn interior lever so that assembly and rose can be placed on spindle. (The lever must be placed level with the tail bar.) Secure lockset with long screws provided.

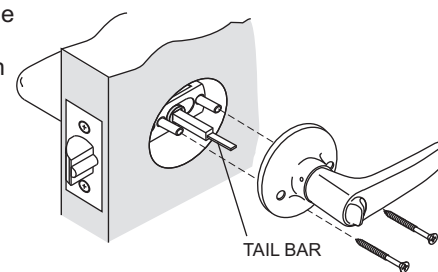

YALE GUARANTEE

ASSA ABLOY warrants its YALE branded products against defects in workmanship and materials, subject to the limitations and exclusions set out in this Warranty. If, within the normal working life of a product, it is found to be defective, and none of the limitations and exclusions set out in this Warranty apply, ASSA ABLOY will supply the same or equivalent product free of charge. This is the only remedy granted by ASSA ABLOY under this Warranty.

Limitations

All electrical and electronic components used in ASSA ABLOY's YALE range of products (excluding batteries) are guaranteed for a period of 12 months from the date of proof of purchase, unless stated otherwise.

Exclusions

This Warranty does not cover:

- 1) Damage to or malfunction or failure of the YALE product caused or contributed to by:
 - a) improper installation or failure to follow fitting instructions;
 - b) improper maintenance;
 - c) fair wear and tear;
 - d) any modification or repair which has not been authorized by ASSA ABLOY;
 - e) use of substitute or replacement parts or cylinders other than genuine ASSA ABLOY parts or cylinders; or
 - f) use of batteries other than those specified by ASSA ABLOY.

- 2) The cost of:
 - a) removal and/or replacement of the YALE product;
 - b) freight and/or traveling time;
 - c) replacement batteries; or
 - d) any modification or repairs to a YALE product, unless authorised by ASSA ABLOY.
- 3) Damage to or deterioration of the plated finishes which are classified as soft finishes, and are subject to deterioration under some environmental conditions.
- 4) Damage caused by corrosion when the Yale product is used in a corrosive environment.
- 5) Personal injury, property damage or economic loss, however caused. This Warranty is in addition to and not in substitution for any rights of the purchaser under individual local legislation where the product is sold.