

fold line

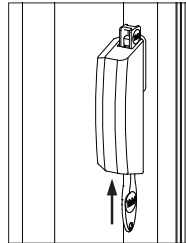

Releasing Restriction

With the window fully closed, insert the release tool into the slot at the bottom of the Guardian Securistay and push firmly until the arm clips up in place.

The window can now be opened un-restricted.

Closing the window automatically re-engages the Guardian Securistay.

VIEW FROM OUTSIDE

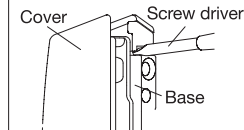

Removing Cover

Care must be taken when removing the cover

- Release the restriction as above and fully open window to allow access to back of Guardian.
- Use a small flathead screwdriver or similar tool to release the top plastic cover clip (see image) Gently remove the cover.

Packer and Screw Selection Chart

The optimum window off-set for Guardian Securistay is 6mm.
Use the enclosed packers to achieve the optimum 6mm window off-set.

	Window off-set	Packer/s	Base Fixing Screw	Hook Fixing Screw
Flush fix	Flush (no off-set, refer to instructions online*)	Base packer 6mm Q60342 	24mm base screw 	9mm hook screw
	5mm to 7mm	No packers required	18mm base screw 	9mm hook screw
Standard Application	8mm to 10mm	Hook packers 1mm and 2mm stackable Q60341 	18mm base screw 	9mm hook screw
	Side fix (off-set of 15mm or more)	Hook side fix packer Q60345 (Hook packers 1mm and 2mm stackable Q60341 can also be used with the side fix packer to pack out hook) 	18mm base screw 	21mm side fix screw (side fixing packer to window sash). 12mm hook screw (fixing hook to packer)

* For flush fix installation instruction please visit www.yalelock.co.nz/guardian and click on downloads



GUARDIAN SECURISTAY SAFER WINDOW VENTILATION

PROFESSIONAL SERIES

TOOLS REQUIRED

- Drill
- 3.2mm drill bit
- Phillips screwdriver
- Tape measure
- Marker pen
- Centre punch
- Safety goggles

CONTENTS

- 1 x Guardian Securistay
- 1x Release tool
- 1 x Marking template
- 1 x Screw pack
- 2 x Packers and adaptors

FEATURES

- Fully releasable and self re-engaging
- Does not protrude into blinds or curtains
- Safer window control in windy conditions

ASSA ABLOY
New Zealand
6 Armstrong Road,
Albany,
Auckland 0632,
New Zealand
Quality, ISO 9001
Environmental, ISO 14001

For customer feedback:
nzsales@assaabloy.com



SYGAWDP (White)
SYGABDP (Black)
SYGASDP (Silver)



GUARDIAN SECURISTAY

SAFER WINDOW
VENTILATION

PROFESSIONAL
SERIES

SAFER VENTILATION

Suitable for aluminium



Made in
New Zealand

Q25046 1117
SYGA



The world's favourite lock
www.yalelock.co.nz

An ASSA ABLOY Group brand

ASSA ABLOY

fold line

fold line



Guardian Securistay For Safer Window Ventilation

Application: Allows safer ventilation when house is occupied.

Operation: Restricts window opening. Arm can be disengaged (only when window is closed) to allow wider window opening. When installed correctly, arm re-engages automatically when window is closed.

Components

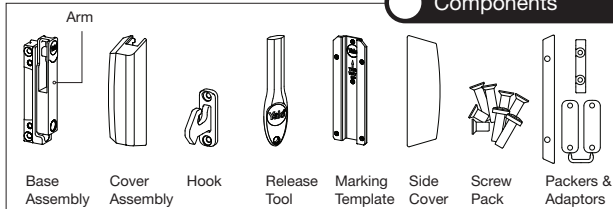

Fixing Instructions

- Determine window offset.
(Distance between frame and sash)
Refer to packer and screw selection chart overleaf to determine a flush fix, standard or side fix application
Select appropriate screws and packers.

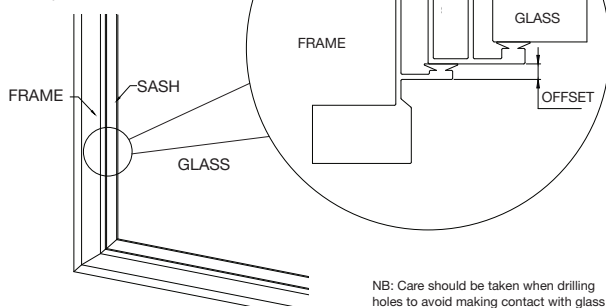

NB: Care should be taken when drilling holes to avoid making contact with glass

Follow this link to
view the installation
video or go to
www.yalelock.co.nz/guardian



Fixing Instructions

- Determine Guardian install height.
Measure window height and find appropriate install height using chart below. Mark height on window.

Window Height	Install Height
<600mm	200mm
600mm - 800mm	300mm
>800mm	400mm

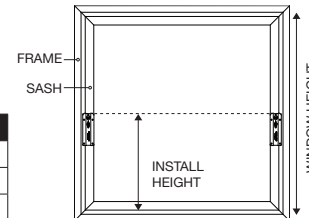

- For side fix applications only.**
Attach side fix adaptor to sash

- Align the top edge of the adaptor with the install height on the window
- Mark and centre punch holes
Hole pitch 25mm, 4mm centres from front sash edge
- Drill 2 x 3.2mm holes

Left hand installation shown for all steps

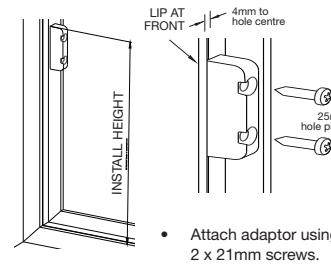

- Drilling Guardian hole positions

- Align top of template with install height mark
- Mark and centre punch holes in frame and sash (or side fix adaptor in side fix applications)
- Drill 2 x 3.2mm frame holes
- Drill 2 x 3.2mm sash holes

Template can be used for both left and right sides of windows.

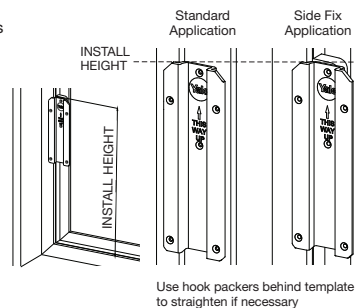

Fixing Instructions

- Attach hook to sash.

- See packer and screw selection chart
- Attach hook to sash using appropriate screws and packers

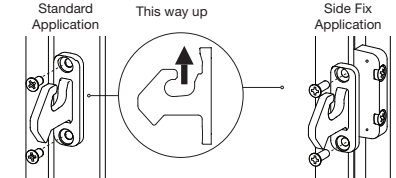

- Attach base to frame.

- See packer and screw selection chart
- Hang arm over hook as shown
- Attach base to frame using appropriate screws

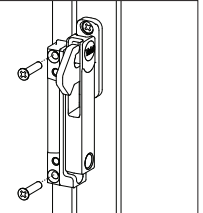

- Clip cover on to base.

- Cycle the window open and shut to check operation
- Open the window to maximum restricted position
- Line up the cover and base as shown and clip on the cover assembly. Push cover firmly to clip in place.

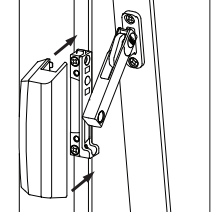

- In situations where the back of the restrictor is visible, press the side cover on to the cover assembly.

