

SMARTair® Product Catalogue

ASSA ABLOY
Opening Solutions

Experience a safer
and more open world



Content

| | |
|--------------------------------|----|
| i-max Escutcheon | 4 |
| Knob Cylinder | 9 |
| Wall Reader - Universal Design | 10 |
| iGate Padlock | 11 |
| Portable Programmer (P.P) | 12 |
| i-Coder | 13 |
| Software & License | 14 |
| Standalone Management Tools | 15 |
| Openow | 16 |
| Accessories | 22 |

SMARTair® Commercial Access Control

SMARTair® friendly access control solution upgrades your security to new levels – with minimal effort on your part.

SMARTair® is an outstanding, modern high security solution, combining exceptional quality with appealing convenience and stylish design. It is ideal for a wide range of organizations and businesses in a wide range of sectors: retirement homes, small hotels, campuses, healthcare facilities, office buildings, sports clubs, government and municipal agencies, airports and many others.

Versatile SMARTair® is available in several versions

SMARTair® Standalone – This basic version of SMARTair® manages access to a single door. Requiring no software or programming device, it relies on a programming card to authorize or cancel electronic access cards and/or PINs.

SMARTair® Update-on-Card (UoC) – SMARTair® Update-on-Card systems are built, operated and managed by the versatile SMARTair® TS1000 software. System management is facilitated by using the users' cards to pass information from the central station to doors throughout the premises.

SMARTair® Wireless – Controlled directly from the system manager's PC, this sophisticated version of SMARTair® notifies managers immediately about events at every door, enabling them to change authorizations and schedules and even open distant doors – without leaving their desks.

SMARTair® Openow Mobile App - Mobile access control: Replace keys and smart-cards with secure credentials stored on a user's smartphone. The facility or security managers can instantly send, update, or revoke the virtual keys using the SMARTair TS1000, management software for maximum control of the facility.



SMARTair® i-max Escutcheon

Standalone, Update on Card Openow or Pro Wireless Openow









The SMARTair® wire-free and battery powered escutcheons are ideal for transit, office or meeting room doors. The wide range of escutcheons offer a RFID reader and locking mechanism in one for all kind of doors.



Pro Wireless + Openow, UoC + Openow



Standalone

| | | |
|--|--|---|
|  | Door profiles | Suitable for timber or aluminium doors |
|  | Traffic volume | Medium to high |
|  | Exterior usage | <ul style="list-style-type: none"> • IP56 • Up to 85% humidity • -20°C to + 70°C |
|  | Hardware compatibility and installation | <ul style="list-style-type: none"> • High retrofit (compatible with mortise locks) • Drilling, no cabling • Doors from 30mm up to 110mm (thicker doors may be possible on request) |
|  | Power supply | <ul style="list-style-type: none"> • Battery (from 75,000 to 105,000 cycles)* max. • 2 years standby** • 3 LR03 AAA 1.5V alkaline batteries |
|  | Multi-authentication | There are 2 models: <ul style="list-style-type: none"> • RFID only • RFID and PIN (keypad) |
|  | Certifications | <ul style="list-style-type: none"> • CE (EMC, R&TTE), ROHS, REACH, WEE, EN1634 (Fire) • EN1906 Category of use Grade 4 • RCM & R-NZ |
|  | RFID technologies | <ul style="list-style-type: none"> • MIFARE Classic and Ultralight • HID iCLASS® **** • SKIDATA**** • DESFire**** |
|  | System management upgradability | Escutcheons can be upgradeable from Standalone <ul style="list-style-type: none"> • Adding RF module • Firmware upgrade • Change of internal cover (plastic top) |

* Depending on reading technology (MIFARE, iCLASS etc.)

** Depending on cycles per day.

***Please consult with Door Hardware Manufacturer before ordering

****Available on request

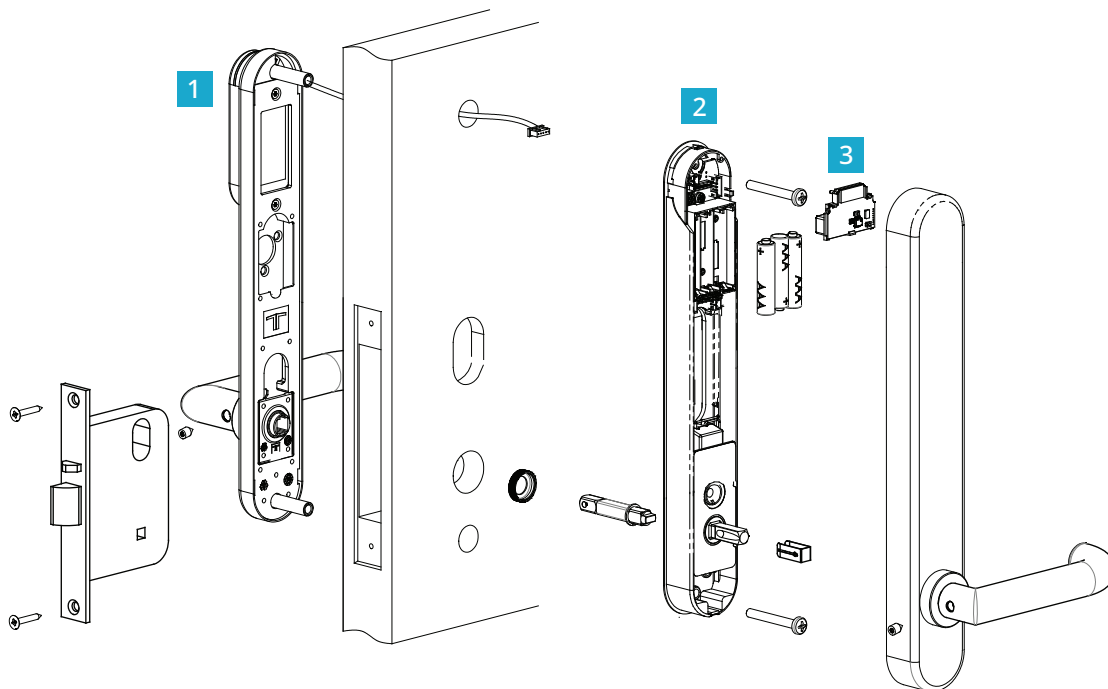

Reader Module 1

- 13,56MHz RFID Technology. Just changing the firmware the electronic escutcheon will work with one of the available reading technologies: MIFARE Classic (or Ultralight), HID iCLASS or DESFire.
- Activation mode. The electronic escutcheon will wake up just by approaching the credential. Without the need to make any previous action.
- Reading distance. 2-4cm. Given by the identification technology.
- Warning LED. Blue or red lights for different warning actions: granted access, access denied, low battery level, etc.
- Connection to the programming device. Through a special cable with three pins. Necessary to initialize the escutcheon and to make emergency openings (in case of low battery level and when there is not mechanical key override).

Control unit and battery module 2

- Non-volatile memory.
- Up to 3.000 users and 1.200 events.
- Real time clock and calendar. Up to 30 time zones with five different periods during the day. Weekdays and weekends automatically recognized. 365 days calendar to define holidays. DST's automatically updated through the calendar.

- Battery module. Easy battery change. Maintains clock and calendar for 5 minutes without batteries. The battery status reported on every event or once per day if no events happen.

Operation modes

Possibility to create state tables in the software, to define automatic changes in the doors (during the day) of the following operation modes:

- Passage mode: The door is open. This operation mode can be established automatically or manually by authorized users.
- First user: The door is closed until the first user with authorized access opens the door. After that operation, the door will remain in passage mode (open).
- Standard: The door is closed and a user with authorized access must approach its credential to open the door.
- Double user: The door is closed and two users with authorized access must approach their credentials to open the door.
- In models with keypad also: Keypad only: the users will enter a door code in the keypad to open the door. Card + PIN: the users must approach the card and after enter their PIN into the keypad to open the door. PIN + Card: the users must enter their PIN into the keypad and after approach their card to open the door.

Special features

- Standard or ADA users. Standard opening time from one to 15 seconds. ADA users will have double time.
- High traffic doors: for unlimited number of users.
- Internal handle detection to detect if a user is leaving the room.
- Door position through a door sensor (not included).

Mobile solutions (Openow/Remote TESA SMARTair App) 3

The electronic escutcheons MUST include: The Wireless + Openow BLE module for both wireless and Openow solutions.

- For Openow solution it is necessary to have the BLE module and activate the Openow functionality in the software license.
- For TESA SMARTair remote opening app it is necessary to have the WIR module and activate the functionality in the software license.
- The internal cover is metallic plus plastic.

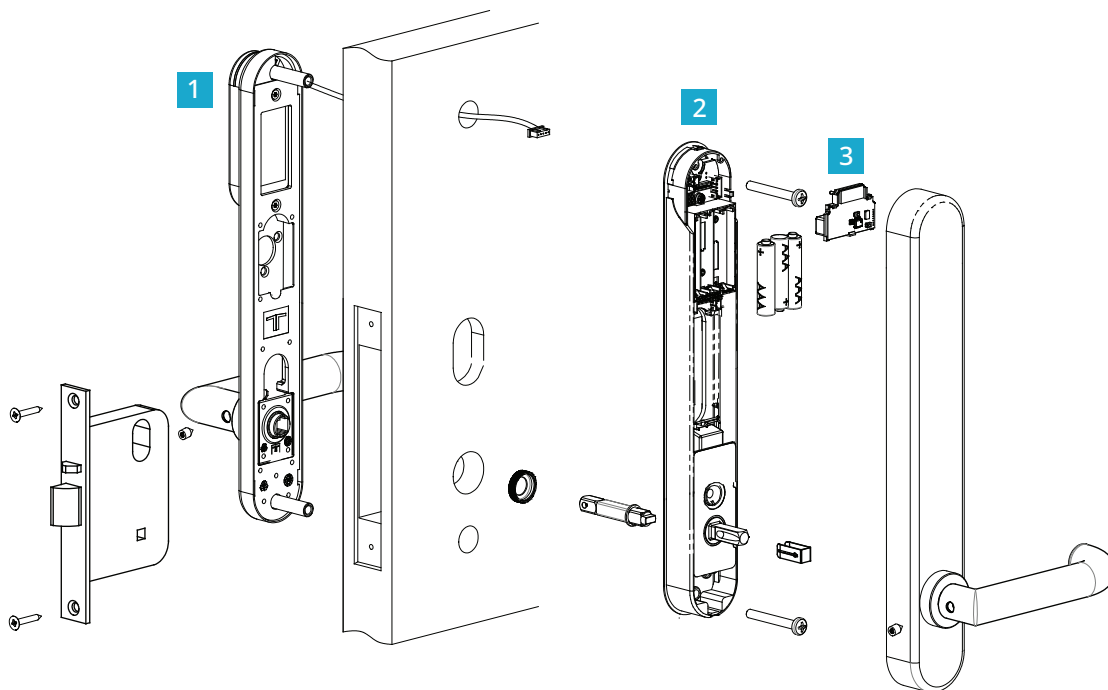

Reader Module 1

- 13,56MHz RFID Technology. Just changing the firmware the electronic escutcheon will work with one of the available reading technologies: MIFARE Classic (or Ultralight), HID iCLASS or DESFire.
- Activation mode. The electronic escutcheon will wake up just by approaching the credential. Without the need to make any previous action.
- Reading distance. 2-4cm. Given by the identification technology.
- Warning LED. Blue or red lights for different warning actions: granted access, access denied, low battery level, etc.
- Connection to the programming device. Through a special cable with three pins. Necessary to initialize the escutcheon and to make emergency openings (in case of low battery level and when there is not mechanical key override).

Control unit and battery module 2

- Non-volatile memory.
- Up to 3.000 users and 1.200 events.
- Real time clock and calendar. Up to 30 time zones with five different periods during the day. Weekdays and weekends automatically recognized. 365 days calendar to define holidays. DST's automatically updated through the calendar.

- Battery module. Easy battery change.

Operation modes

Possibility to create state tables in the software, to define automatic changes in the doors (during the day) of the following operation modes:

- Passage mode: The door is open. This operation mode can be established automatically or manually by authorized users.
- First user: The door is closed until the first user with authorized access opens the door. After that operation, the door will remain in passage mode (open).
- Standard: The door is closed and a user with authorized access must approach its credential to open the door.
- Double user: The door is closed and two users with authorized access must approach their credentials to open the door.
- In models with keypad also: Keypad only: the users will enter a door code in the keypad to open the door. Card + PIN: the users must approach the card and after enter their PIN into the keypad to open the door. PIN + Card: the users must enter their PIN into the keypad and after approach their card to open the door.

Special features

- Standard or ADA users. Standard opening time from one to 15 seconds. ADA users will have double time.

- High traffic doors: for unlimited number of users.
- Internal handle detection to detect if a user is leaving the room.
- Door position through a door sensor (not included).

Mobile solutions 3 (Openow/3 Mobile Solution)

The electronic escutcheons MUST include the following RF module:

- Openow BLE module for offline and UOC solution.
- It is also necessary to activate the Openow functionality in the software license.

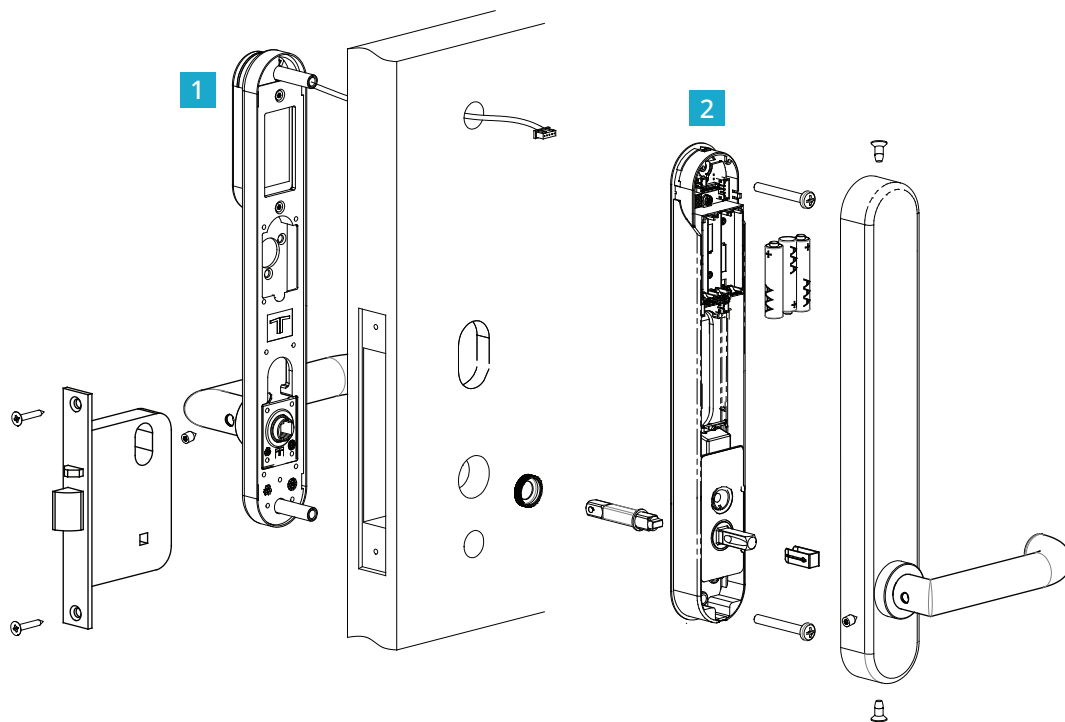

Reader Module 1

- 13,56MHz RFID Technology. Just changing the firmware the electronic escutcheon will work with one of the available reading technologies: MIFARE Classic (or Ultralight), HID iCLASS or DESFire.
- Activation mode. The electronic escutcheon will wake up just by approaching the credential. Without the need to make any previous action.
- Reading distance. 2-4cm. Given by the identification technology.
- Warning LED. Blue or red lights for different warning actions: granted access, access denied, low battery level, etc.
- Connection to the programming device. Through a special cable with three pins. Necessary to initialize the escutcheon and to make emergency openings (in case of low battery level and when there is not mechanical key override).

approach their card to open the door.

Special features

- Standard or ADA users. Standard opening time from one to 15 seconds. ADA users will have double time.
- High traffic doors
- Internal handle detection to detect if a user is leaving the room.

Control unit and battery module 2

- Non-volatile memory.
- Battery module. Easy battery change.

Operation modes

- In models with keypad also: Keypad only: the users will enter a door code in the keypad to open the door. Card + PIN: the users must approach the card and after enter their PIN into the keypad to open the door. PIN + Card: the users must enter their PIN into the keypad and after

Mechanical Characteristics

Compatible with Lockwood Synergy and Selector NO HUB DISC mortice locks with varying backsets

Mortise Lock

- Compatible with Lockwood NO HUB DISC mortice locks with varying backsets ie 30mm, 38mm, 60mm
- 7.6mm spindles

Door width

- Suitable for doors with a thickness from 30 to 110mm
- Spindle is dismountable, for flexibility in field

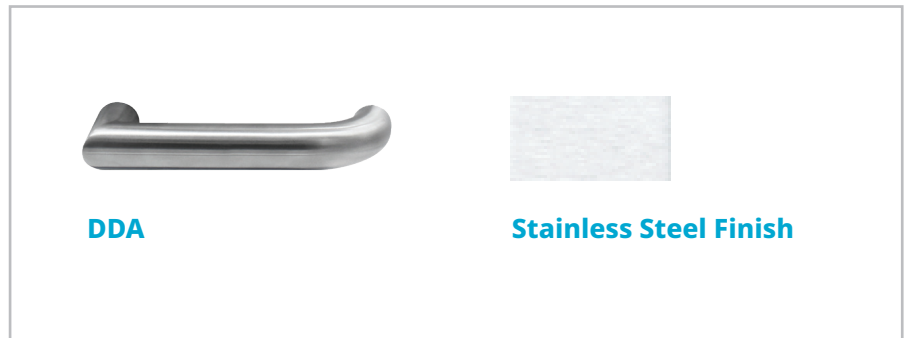

External Handle

- Freewheeling handle connects to spindle when access is granted

Internal Handle

- Free exit, internal handle always opens door

| S | 4 | A | B | 4 | 2 | X | L | 2 | V | 6 | 4 | 8 | D | I |
|--|---|---|---|---|---|---|---|---|---|--|---|---|--|---|
| System Management Technology | | | | Reader Type | | | Escutcheon Model | | | Hub to Cylinder Distance | | | Handle Style & Finish | |
| SNAB: STANDALONE S4BB: UPDATE ON CARD + OPENOW S4ZB: PRO WIRELESS + OPENOW | | | | 42X: MIFARE RFID, IP56 46X: MIFARE RFID + KEYPAD, IP56 | | | L2V INTERNAL: BLIND EXTERNAL: WITH KEY OVERRIDE | | | 648: 64MM, FOR STANDARD LOCK 908: 90MM, FOR NARROW LOCK | | | D: DDA (Standalone) R: DDA (UOC & Wireless) I: STAINLESS STEEL | |

Ordering Information

| i-max Escutcheon | System management | RFID | KeyPad | Openow BLE | Key Override | Compatible Mortice Lock |
|------------------|-------------------------|------|--------|------------|--------------|---|
| SNAB42XL2V648DI | STANDALONE | ✓ | | | ✓ | Suitable with 64mm NO HUB DISC Lock 3772NOHDSS - Selector 60MM backset 5772NOHDSS - Selector 127MM backset |
| SNAB46XL2V648DI | STANDALONE | ✓ | ✓ | | ✓ | |
| S4BB42XL2V648RI | UPDATE ON CARD + OPENOW | ✓ | | ✓ | ✓ | |
| S4BB46XL2V648RI | UPDATE ON CARD + OPENOW | ✓ | ✓ | ✓ | ✓ | |
| S4ZB42XL2V648RI | PROWIRELESS + OPENOW | ✓ | | ✓ | ✓ | |
| S4ZB46XL2V648RI | PROWIRELESS + OPENOW | ✓ | ✓ | ✓ | ✓ | |
| SNAB42XL2V908DI | STANDALONE | ✓ | | | ✓ | SUITABLE WITH 90MM NO HUB DISC LOCK 3782ENOHDSS - SELECTOR 23MM BACKSET 4782ENOHDSS - SELECTOR 25.4MM BACKSET 5782ENOHDSS - SELECTOR 30MM BACKSET 6782ENOHDSS - SELECTOR 38MM BACKSET |
| SNAB46XL2V908DI | STANDALONE | ✓ | ✓ | | ✓ | |
| S4BB42XL2V908RI | UPDATE ON CARD + OPENOW | ✓ | | ✓ | ✓ | |
| S4BB46XL2V908RI | UPDATE ON CARD + OPENOW | ✓ | ✓ | ✓ | ✓ | |
| S4ZB42XL2V908RI | PROWIRELESS + OPENOW | ✓ | | ✓ | ✓ | |
| S4ZB46XL2V908RI | PROWIRELESS + OPENOW | ✓ | ✓ | ✓ | ✓ | |

* 570 Cylinder not included

SMARTair® Knob Cylinder

Function

The SMARTair Knob Cylinder is an easy-to-use, simple-to-install and highly effective electronic cylinder that can be integrated with other SMARTair locking elements – escutcheons, wall readers – in one Access Control system managed by SMARTair Software.

Mechanical features

- Freewheeling knob until an authorized credential is presented
- Motorized clutch activates cylinder cam
- Compatible with Lockwood commercial mortise locks (oval cylinder, 570) & Euro profile locksets

Electronic features

• Reader module:

- 13.56 MHz, MIFARE® or iClass technology (available on request)
- Contact-less cards/tags
- Reading distance: 10mm-20mm, given by the identification technology
- Programming device connection located on the front section of the electronic knob
- Indication light: Red LED

• Control Unit:

- Non-volatile memory
- 3000 users and 1000 events
- High traffic: All users of the installation have access and 1,000 audit trail entries

- Real-time clock and calendar: Up to 30 time zones with five different periods during the day. Weekdays and weekends automatically recognized. 365 days calendar to define holidays. DST's automatically updated through the calendar.

• Battery module:

- -1 x CR123A Lithium battery
- -Estimated battery life: 60,000 cycles; 2 years in standby (for the wireless model: 1-2 years in standby)
- -Simple battery change; no dismantling required

Specifications

- 85% humidity without condensation
- Temperature range: from -20°C to 70°C
- Internal side: 0°C to 50°C
- IP56



Ordering Information

| Product Description | Part Number |
|---|-----------------|
| SmartAir Knob Cylinder, S/Alone, Mifare, Black, IP55 | SNAB42X030E10MI |
| SmartAir Knob Cylinder, UOC/OpenNow, Mifare, Black, IP55 | SNBB42X030E10MI |
| Smartair Knob Cylinder R4 Prowireless Openow Ble Mifare 30mmelec/10mmmechhalf | SNZB42X030E10MI |

SMARTair® Wall Reader - Universal Design

(Standalone, Update-On-Card, Wireless)

Function

The SMARTair Wall Reader is a unique and elegant access control solution designed for simple installation and operation. The Wall Reader operates electromagnetic locks, electric strike or electronic locks. All the control elements are on the inside of the door to enhance security.

Applications

Access control for commercial and institutional facilities including offices, hospitals, factories, schools, sports clubs and more.

Features

- Simple installation
- Simple operation
- **System management through easy-to-use software**
- Authorizations
- Time schedules
- Daylight savings time and holidays
- Deletion and replacement of lost tags
- Audit trails

- Temporary blockage
- 4-digit code
- 4 operation modes: Standard; Open; First user; Double user
- Up to 64,000 user cards and up to 64,000 doors per system

Specifications

- 13.56 MHz, MIFARE® or iClass technology (available optionally)
- Contactless cards/tags
- 2-4 cm read/write distance
- Temperature range: -10°C to 80°C
- **12V AC/DC power consumption:**
- Relay not active: 20µA
- Relay active: 150mA
- Relay: NO, NC, C
- Wireless frequency: 915 MHz

Options

- **With or without keypad - RFID only**
- RFID and code
- Code only



| S | N | B | R | 2 | P | N | S | S | B |
|--|---|---|---|-------------------------------|---|--|----------------|---|---|
| System Management Technology | | | | Reader Type | | Relay Board | Finish | | |
| SNBR: UPDATE ON CARD + OPENOW SNZR: PRO WIRELESS + OPENOW | | | | 2P: MIFARE RFID 2K: KEYPAD | | N/NU: WITHOUT RELAY BOARD RU: 8 RELAY BOARD | STANDARD BLACK | | |

Ordering Information

| | System management | RFID | KeyPad | Relay Board |
|-------------|-------------------------|------|--------|-------------|
| SNBR2PNUSSB | UPDATE ON CARD + OPENOW | ✓ | | Without |
| SNBR2PRUSSB | UPDATE ON CARD + OPENOW | ✓ | | 8 |
| SNBR2KNSSB | UPDATE ON CARD + OPENOW | ✓ | ✓ | Without |
| SNBR2KRUSSB | UPDATE ON CARD + OPENOW | ✓ | ✓ | 8 |
| SNZR2PNUSSB | PROWIRELESS + OPENOW | ✓ | | Without |
| SNZR2PRUSSB | PROWIRELESS + OPENOW | ✓ | | 8 |
| SNZR2KNSSB | PROWIRELESS + OPENOW | ✓ | ✓ | Without |
| SNZR2KRUSSB | PROWIRELESS + OPENOW | ✓ | ✓ | 8 |









SMARTair® iGate Padlock

Function

A new padlock with a renewed design. High robustness with a contemporary design, including wireless online, RFID and BLE connectivity and a sophisticated warning LED. Special for gates, closets, cabinets, etc.

The i-gate padlock is built by the assembling of one knob cylinder, the padlock and all together protected with a cover. The padlock includes the electromechanical clutch that will work together with the padlock. Allowing the opening of the padlock (or not) according to the instructions of the control unit.



| | | |
|--|--|---|
|  | Door profiles | External gates, closets, cabinets, etc. |
|  | Traffic volume | Medium to high |
|  | Exterior usage | <ul style="list-style-type: none"> • IP68 Certification. Resistant to real extreme weather conditions • Up to 85% humidity • -20°C to + 70°C |
|  | Hardware compatibility and installation | <ul style="list-style-type: none"> • High retrofit • No drilling, no wiring |
|  | Power supply | <ul style="list-style-type: none"> • Battery (60.000 cycles)* max. Depending on the reading technology (MIFARE, DESFire, Etc.) • Max. 2 years standby (depending on cycles per day) • Type of batteries: One CR2 3V Lithium battery |
|  | Multi-authentication | No |
|  | Certifications | <ul style="list-style-type: none"> • CE (EMC, R&TTE), ROHS, REACH, WEE, Durability EN15684 Class 6, IP68 • RCM & R-NZ |
|  | RFID technologies | <ul style="list-style-type: none"> • 13,56MHz Read & Write technologies • MIFARE Classic and Ultralight, • HID iCLASS, DESFire, SKIDATA |
|  | System management upgradability | Compatible with all SMARTair systems: <ul style="list-style-type: none"> • Offline/Update on card + Openow • Wireless + Openow • Upgraded from Offline/Update on Card + Openow -> Wireless + Openow • Both options just changing the firmware with the programming device. |

| | | | | | | | |
|---|---|---|---|--------------------|---|------------------|---------------|
| S | N | B | R | P | 2 | X | I |
| System management Technology | | | | Reader Type | | IP Rating | Finish |
| SNBB UPDATE ON CARD + OPENOW SNZB: PRO WIRELESS + OPENOW | | | | P2: MIFARE RFID | | X: IP68 | RUBBER GASKET |

Ordering Information

| Product Description | Part Number |
|--|-------------|
| Smartair I-Gate Padlock R4 Offline Update On Card Openow Mifare Ip68 | SNBBP2XI |
| Smartair I-Gate Padlock R4 Prowireless Openow Mifare Ip68 | SNZBP2XI |

SMARTair® Portable Programmer (P.P)

The SMARTair Portable Programmer allows site management personnel to initialise and update doors with site information as well as download audit trail from devices.

Functionality

- Initialise the devices: The Portable Programmer (P.P.) transfers the locking plan information from the PC to the locks. This includes details of authorised users, calendar, time zones and door states.
- Update the device: Transfer of locking plan updates to the devices
- Emergency opening of devices in case of battery failure
- Testing of the door device information to ensure correct operation
- Audit trail collection
- Update or migration of device firmware

Mechanical Characteristics

- Dimensions:
175 (H) x 92 (A) x 30 (P) mm ·

Electronic Characteristics

- Membrane Keyboard.
- Power Supply - 9V 6LR61 type non-rechargeable
- Memory 0.5 MB.

Environmental Characteristics

- Operating Temperature and Humidity: 0°C ~ 60°C with relative humidity of 90%.

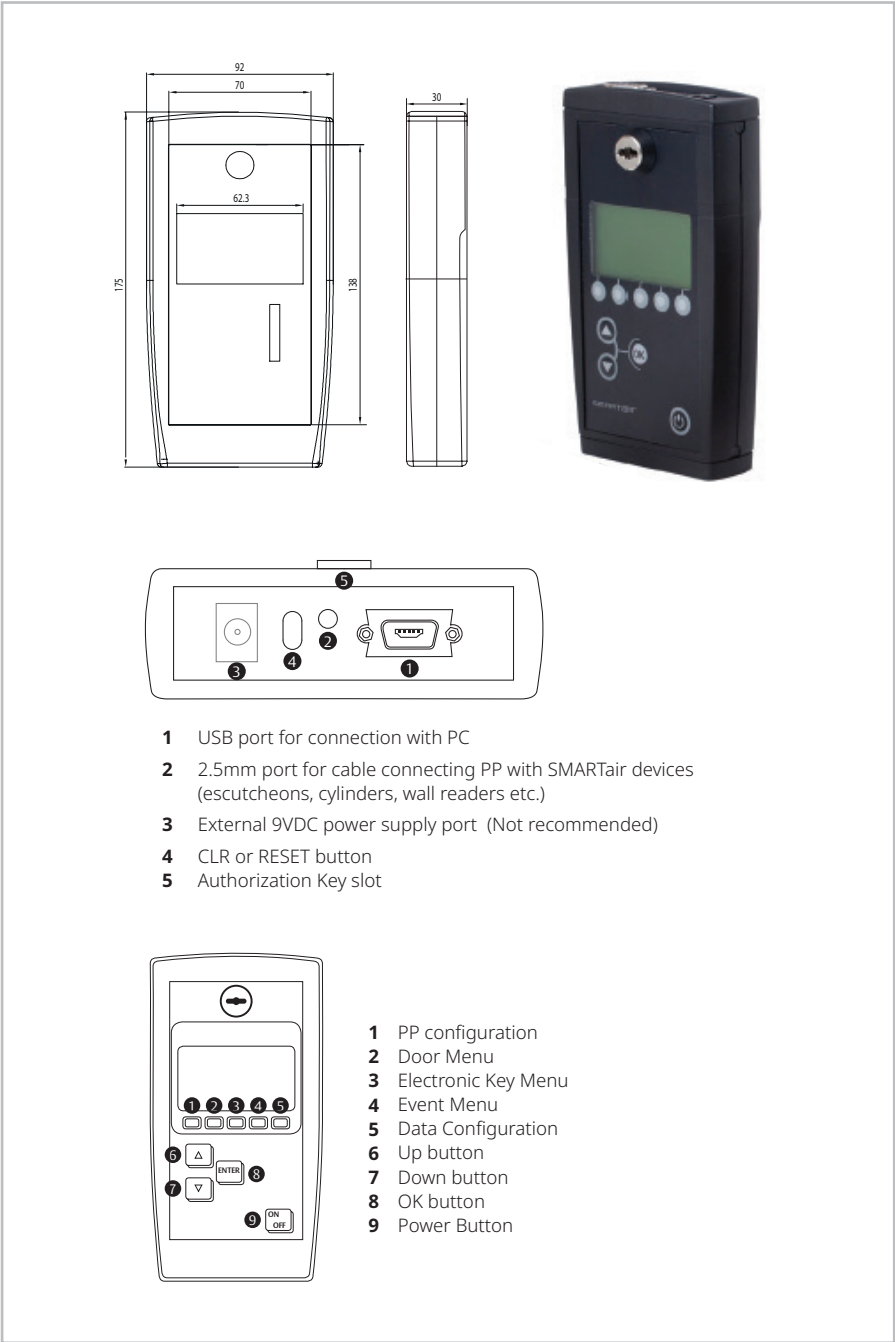

| Ordering Information | |
|----------------------|-------------|
| Product Description | Part Number |
| Portable Programmer | STCPCC |

SMARTair® i-Coder

Function

The SMARTair Encoder is a device that encodes and reads user credentials using the SMARTair software.

Specifications

- **Reader module:**
 - 13.56 MHz, MIFARE® RFID technology
 - ISO 14443A
 - Contactless cards
 - Reading range: 10 mm with standard credentials
 - LED indications (access authorized, access denied etc).
- **Power cable** – supplied with the encoder:
 - Input: 100-240V 50/60 Hz 1.0A
 - Output: 7.5V 1.2A
- **USB connection to the PC** – supplied with the encoder
- **Red, Blue and Green indications**

Credentials

- Read/write contactless chip identification technology RFID 13.56 MHz - MIFARE Classic 1K, 4K, and ULTRALIGHT
 - iClass 2k/2, 16k/2, 16k/16, 32k
- **Credential type:**
 - Card
 - Tag
 - Transponder sticker



Ordering Information

| Product Description | Part Number |
|-----------------------------------|-------------|
| Smartair Card Icoder Usb Smartair | SNCED3USB |

SMARTair® Software & License

Function

SMARTair Software (also called TS1000) enables users to manage the SMARTair system according to the license issued and the associated Authorization Key.

The SMARTair Software license includes:

- **A USB memory device that contains:**
- -SMARTair Software installation file
- -Site data (the license)
- -Technical manuals
- -Authorization key programmed with the system code

The easy-to-use SMARTair Software manages all types of SMARTair products – escutcheons, wall readers, cabinet locks, knob cylinders and others – simultaneously.

Global Lockdown:

SMARTair Wireless Online also offers advanced Lockdown functionality. In an emergency requiring Global Lockdown, facility managers can change the operating mode of every wireless door device simultaneously. The license needs to be activated for this function.

Remote Opening App:

The TESA SMARTair remote opening app enables facility and security managers to remotely open their site doors from anywhere.

Software requirements

- PC with Pentium 4 processor or higher
- 1 GB of free RAM
- 1 GB or free disk space
- 32-bit or 64-bit Microsoft Windows Operating System supporting services (Windows 95, Windows 98 and Windows ME are not supported)

Site data

- The 'site data' is supplied with the software and includes the license for the system and a unique 8-figure alphanumeric system code
- All information regarding the system (user list, door list, authorization matrix, time profiles, etc) is kept in the site data file

Authorization Key

- The Authorization Key enhances security for the SMARTair system
- Each Authorization Key contains the system's unique corresponding system code
- In order for the Portable Programmer to

function, the Authorization Key must be inserted.

Types of licenses

- For the different products (upgrades available):
- UoC+Openow
- Wireless+Openow+Remote App
- According to the number of doors in the system (upgrade available):
- Up to 10 doors
- Up to 30 doors

- Up to 75 doors
- More than 75 doors

SMARTair Management kit Contents

- a) TS1000 Software License (with Authorising Key)
- b) 1 x Portable Programmer
- c) 1 x Card i-coder
- d) 50 x MIFARE Classic User Cards
- e) Associated cables



Ordering Information

| Product Description | Part Number |
|--|-----------------|
| SMARTAIR STANDARD OFFLINE OPENOW MANAGEMENT KITS 10 DOORS | SNCKKITOFF10MFD |
| SMARTAIR STANDARD OFFLINE OPENOW MANAGEMENT KITS 30 DOORS | SNCKKITOFF30MFD |
| SMARTAIR STANDARD OFFLINE OPENOW MANAGEMENT KITS 75 DOORS | SNCKKITOFF75MFD |
| SMARTAIR STANDARD OFFLINE OPENOW MANAGEMENT KITS UNLIMITED DOORS | SNCKKITOFFMFD |
| SMARTAIR STANDARD UPDATE ON CARD OPENOW MANAGEMENT KITS 10 DOORS | SNCKKITUOC10MFD |
| SMARTAIR STANDARD UPDATE ON CARD OPENOW MANAGEMENT KITS 30 DOORS | SNCKKITUOC30MFD |
| SMARTAIR STANDARD UPDATE ON CARD OPENOW MANAGEMENT KITS 75 DOORS | SNCKKITUOC75MFD |
| SMARTAIR STANDARD UPDATE ON CARD OPENOW MANAGEMENT KITS UNLIMITED DOORS | SNCKKITUOCMFD |
| SMARTAIR STANDARD WIRELESS OPENOW REMOTE APP MANAGEMENT KITS 10 DOORS | SNCKKITWIR10MFH |
| SMARTAIR STANDARD WIRELESS OPENOW REMOTE APP MANAGEMENT KITS 30 DOORS | SNCKKITWIR30MFH |
| SMARTAIR STANDARD WIRELESS OPENOW REMOTE APP MANAGEMENT KITS 75 DOORS | SNCKKITWIR75MFH |
| SMARTAIR STANDARD WIRELESS OPENOW REMOTE APP MANAGEMENT KITS UNLIMITED DOORS | SNCKKITWIRMFH |
| SMARTAIR UPGRADE TS1000 WITH LOCKDOWN | SNCKLICLOCKDOWN |
| SMARTAIR WIRELESS REMOTE OPENING MOBIL APP | SNCKLICMOBILE |

SMARTair® Standalone Management Tools

Function

SMARTair® Standalone is the basic version of SMARTair® and manages access to a single door. Requiring no software or programming device, it relies on a friendly programming card to authorize or cancel electronic access cards and/or PINs.

The Standalone Management Tools include:

- Programming Card - used to program the SMARTair® escutcheon, wall reader or knob cylinder
- Emergency cable - used to allow the opening of a door when the batteries are flat

Programming Card features:

- Add credential
- Cancel credential
- Cancel all credentials
- Passage mode control
- Shadow Card (to delete a lost credential)

Programming Card options:

- With Shadow Card feature
- Without Shadow Card features



Emergency Cable features:

- Used to energize the lock in order to open the door when the escutcheon's batteries are empty
- Requires 3 x AAA batteries

| Ordering Information | |
|---|---------------|
| Product Description | Part Number |
| SMARTAIR STANDARD STANDALONE MANAGEMENT KIT a) 3 programming card (Standard Programming Card, Reset card, Emergency Card) b) 25x Mifare user cards c) 1x Emergency Jumpstart Battery kit | SNACKITSTA |
| SMARTAIR SHADOW STANDALONE MANAGEMENT KIT a) 3 programming card (Shadow Programming Card, Reset card, Emergency Card) b) 25x Mifare user cards c) 1x Emergency Jumpstart Battery kit | SNACKITSTASDW |

Openow™ from SMARTair® combines access control technology with mobile intelligence

Openow™ is the intelligent mobile solution for access control. Make your workplace mobile-ready with SMARTair®

With Openow™, you can send virtual keys to any smartphone, so users open doors securely and conveniently.

Site users download the App, available for IOS and Android, and complete our fast, secure email registration. Right away you can send them virtual keys - so they open doors with their mobile phone, without jeopardizing the security of your buildings.

Tap a SMARTair® lock with your phone carrying a valid virtual key, and the door unlocks.

Your business takes a step into the future: upgraded, mobile-ready security and more convenience for everyone.

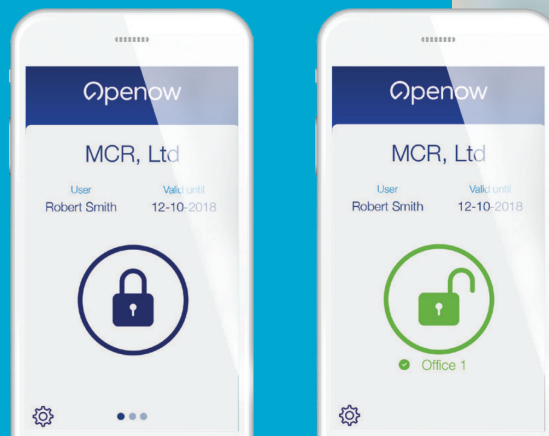

SMARTair® Openow

Openow™ makes your SMARTair® access control system mobile

- SMARTair® is a powerful access control system, simple to install, configure, administer and maintain. It adapts to any size of building and perfectly integrates with your existing door security.
- And now, with the Openow™ solution from SMARTair®, you can convert your smartphone into a key.
- Users can conveniently open doors with their smartphone while it provides facility managers with great flexibility in handling virtual keys.
- Our Openow™ mobile solution is suitable for both new and existing SMARTair® installations, as only few steps are required to upgrade your site to make it mobile ready.



The system includes:

Whatever your premises and needs, SMARTair® has the right solution:

Software

The SMARTair® TS1000 administration software is intuitive and can be accessed from any device (PC, tablet or mobile phone) with a standard browser.

Credentials

Openow, the App for smartphones, is now available. Mobile solution can be combined with other existing credentials (cards, tags) in the same installation.

Knob cylinders

For management and admin doors, knob cylinders are the right choice.

Escutcheons

Robust, slim design escutcheons, ideal to equip any type of exterior or interior door or access point (wooden doors, aluminium-profile doors, fire resistant doors and escape routes).

Wall readers

For entrance doors, car parks, lifts and common areas with high traffic flows, wall readers are the best option.

Ordering Information

| Product Description | Part Number |
|---|----------------|
| Annual fee for license upgrade to smartair openow 10 doors | STCUPOPENOW10* |
| Annual fee for license upgrade to smartair openow 30 doors | STCUPOPENOW30* |
| Annual fee for license upgrade to smartair openow 75 doors | STCUPOPENOW75* |
| Annual fee for license upgrade to smartair openow unlimited doors | STCUPOPENOW* |

*The license including the site name and passwords are required to be provided to ASSA ABLOY NZ after placing an order. The license with the Openow enabled will be returned to the customer. The Openow enabled will be completed by TESA (Spain). The Openow license is a functionality that should be renewed annually.

SMARTair® Openow



So simple, so fast, so intuitive with Openow™

Functionality for security managers; Security managers instantly send, revoke or update Openow™ virtual keys directly from the TS1000 software or web browser. Virtual keys are securely deployed over-the-air to anywhere in the world.

Secure data transmission for all communications is ensured by these industry protocols:

- Encrypted https secure connection between the TS1000 software and every user's smartphone.
- AES128 with diversified keys encryption for all communications between smartphone and door devices.



Send keys



Revoke keys



Update keys

**TS1000 administration
software & web client**





Functionality for users

For users it's easy to take advantage of this new mobile access solution. Just download the app and receive your key immediately, regardless of where you are. It allows you to hold as many virtual keys as needed. It does not matter how far you go. This feature is especially designed for professionals working in different locations.



Multiple keys



Door opening



No physical key

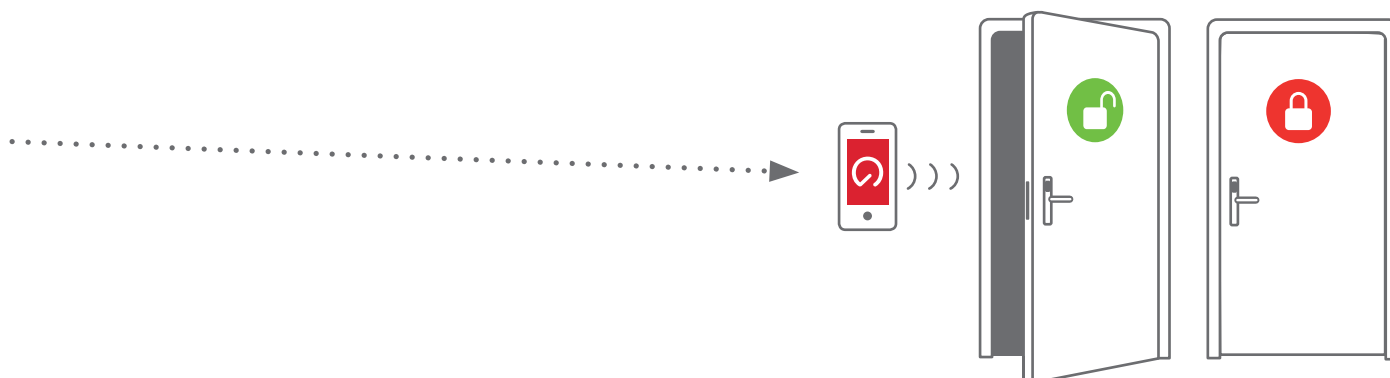

SMARTair® Openow



A leap forward for convenience in every business

Openow™ is the perfect solution for facilities with people on the move or a high volume of visitors and subcontractors. It is built for businesses where third-party contractors are always on-site, and companies whose staff travel regularly to remote locations.

Health

- Provide doctors, nurses, medical staff, contractors, temporary personnel and service companies with virtual keys, without creating resource bottlenecks around a single issuing point.
- Users only enter specific areas to which they are granted access (entrance hall, pharmacy, laboratory or laundry) with no need to carry any physical credential but their smartphone.
- Instantly cancel virtual keys without waiting for a user to return their card, ensuring your premises remain secure.

Queues at the reception desk, temporary access for cleaning staff... The key to solving these issues in hospitals, universities, museums, offices, multinationals, co-working spaces and ministries is Openow™ from SMARTair®.

Education

- Students and teaching staff enjoy the benefits and convenience of mobile technology, with keys on their smartphones and no need to collect them from reception or admin offices.
- Openow™ works with all wireless compatible SMARTair® devices, enabling your smartphone to open the main entrance door, the library or the teachers' offices.
- When a virtual key is revoked, it automatically disappears from the app, ensuring ongoing security and site integrity.

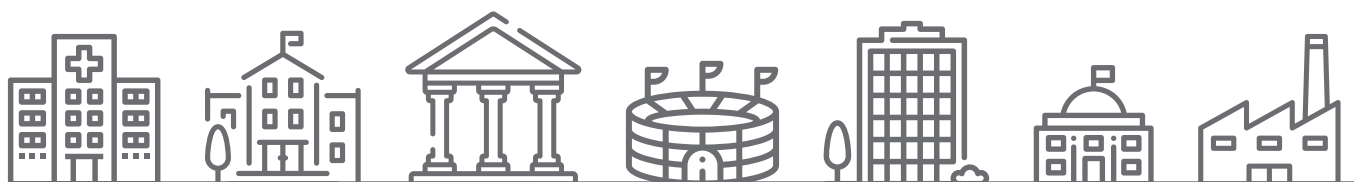

Offices and businesses

- Enhance the experience: visitors receive a virtual key straight to their phone and your workplace is mobile-ready.
- Access points to areas with high footfall – such as collaborative spaces or co-working areas – no longer need a 24/7 reception desk to hand credentials to visitors.
- With Openow™, you can send virtual keys to visitors ahead of arrival, and schedule them to activate at the relevant time.

Public institutions

- For the hundreds of visitors who arrive every day and move around the site, Openow™ from SMARTair® is the mobile-ready solution you have been waiting for.
- Convenient for employees: store multiple virtual keys on your mobile phone, each with individually programmed permissions for different sites.
- Time-saving for visitors: no more queues at reception, no more waiting for physical keys or the smart-card terminal, because your mobile phone is your key.

SMARTair® Accessories



Ordering Information

| Product Description | Part Number |
|--------------------------|----------------|
| SMARTAIR WIRELESS HUB V3 | STWIRELESSHUB6 |



Ordering Information

| Product Description | Part Number |
|--|--------------|
| SMARTAIR WIRELESS PRO TESTER | SNZWIRTESTER |
| a) Wireless Hub | |
| b) Signal Measurement Tool (Escutcheon shaped) | |



Ordering Information

| Product Description | Part Number |
|-----------------------------|--------------|
| R4 MODULE WIRELESS + OPENOW | SBCMODULEWRB |

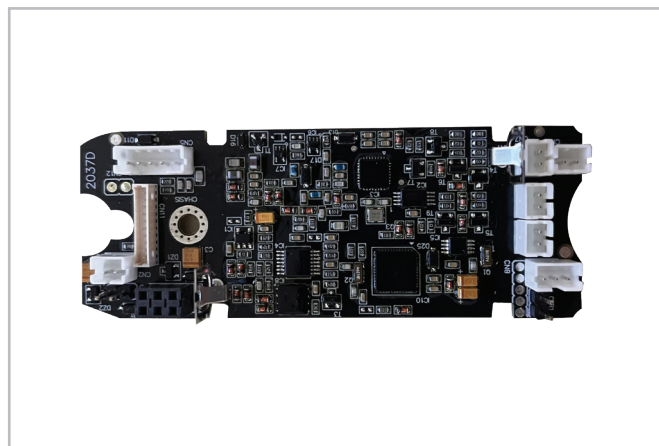

Ordering Information

| Product Description | Part Number |
|--|-----------------|
| SMARTAIR R4 CONTROL BOARD STAND ALONE | SNAC12CONTROLR4 |
| SMARTAIR R4 CONTROL BOARD OFFLINE/UOC | SNCC12CONTROLR4 |
| SMARTAIR R4 CONTROL BOARD WIRELESS | SNZC12CONTROLR4 |

SMARTair® Accessories



Ordering Information

| Product Description | Part Number |
|--|----------------|
| SMARTAIR CONVERTOR PC TO LOCK PROGRAMMER TESA UNIV | STUSBPCTOLOCKU |
| SMARTAIR R.CABLE PP V2 BIFI(JACK+PINS) | PPCABLEBIF |



Ordering Information

| Product Description | Part Number |
|--|-------------------|
| Smartair Mifare Classic Standard 4k Card | SNCLC204 |
| Smartair Mifare Classic Standard 1k Tag | STCLLAS2N |
| Smartair Mifare Classic Standard 1k Tag - Engraved | STCLLAS2NENGRAVED |



Ordering Information

| Product Description | Part Number |
|---|-----------------|
| SMARTair Spindle Kit, Suitable For Door Thickness | |
| 30-38MM | STCCSPIAKIT3038 |
| 38-44MM (supplied as default in all escutcheon boxes) | STCCSPIAKIT3844 |
| 44-50MM | STCCSPIAKIT4450 |
| 50-56MM | STCCSPIAKIT5056 |
| 56-62MM | STCCSPIAKIT5662 |

| | |
|-----------|-----------------|
| 62-68MM | STCCSPIAKIT6268 |
| 68-74MM | STCCSPIAKIT6874 |
| 74-80MM | STCCSPIAKIT7480 |
| 80-86MM | STCCSPIAKIT8086 |
| 86-92MM | STCCSPIAKIT8692 |
| 92-98MM | STCCSPIAKIT9298 |
| 98-104MM | STCCSPIAKIT9804 |
| 104-110MM | STCCSPIAKIT0410 |

The ASSA ABLOY Group is the global leader in access solutions. Every day we help people feel safe, secure and experience a more open world

ASSA ABLOY

ASSA ABLOY New Zealand Ltd.
PO Box 100407, North Shore
Auckland 0745

6 Armstrong Road, Albany
Auckland 0632
New Zealand

Within New Zealand:
Tel 09 448 9188
Fax 0800 478 297
www.assaabloy.com/nz

Outside New Zealand:
Tel +64 9 448 9188
Fax +64 9 415 7889
www.assaabloy.com/nz