

Pinnacle Mortice Sliding Door Lock

ASSA ABLOY

The global leader in
door opening solutions.

Installation Instructions

Application: Provides secure deadlocking for aluminium sliding doors.

Tools Required:

- Drill
- 3.2mm Drill Bit
- Square Screwdriver #1

Pack Contents:

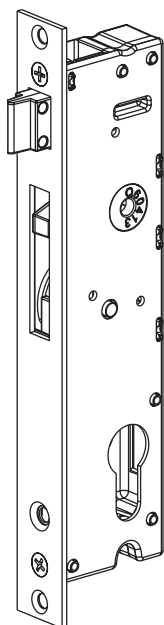

1-Point Lock



Strike

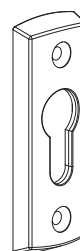

Internal Cylinder
Escutcheon

and

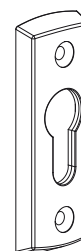

External Cylinder
Escutcheon
(double cyl
cyl/turn only)

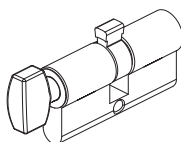

Cylinder Key & Turn Knob
(or half turn version)

or

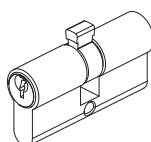

Cylinder Double Key
(or half cylinder version)

or

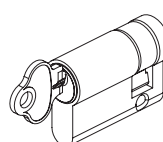

or

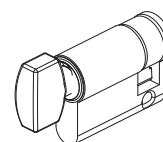

M5 Cylinder fixing Screw



8g x 5/8 escutcheon Screw



8g x 7.5mm Screws

1. Door Preparation

Route the door as shown in the routing diagram.

30mm BACKSET ROUTING IS 28mm FROM THIS FACE
35mm BACKSET ROUTING IS 33mm FROM THIS FACE
40mm BACKSET ROUTING IS 38mm FROM THIS FACE

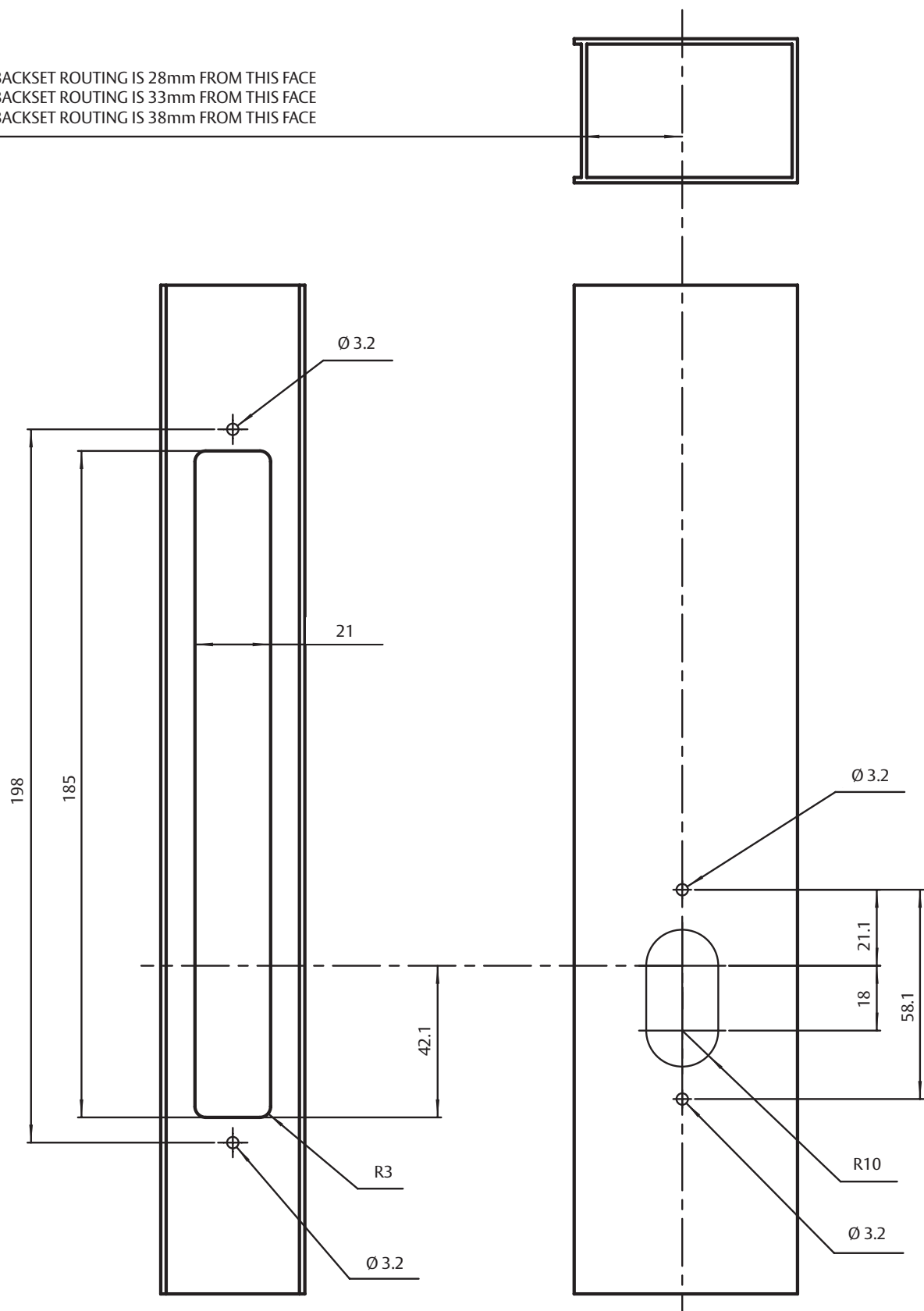

Note: Cutout FOR 1/2 cylinder
ON INSIDE ONLY

CUTOUT full cylinder
ON BOTH SIDES

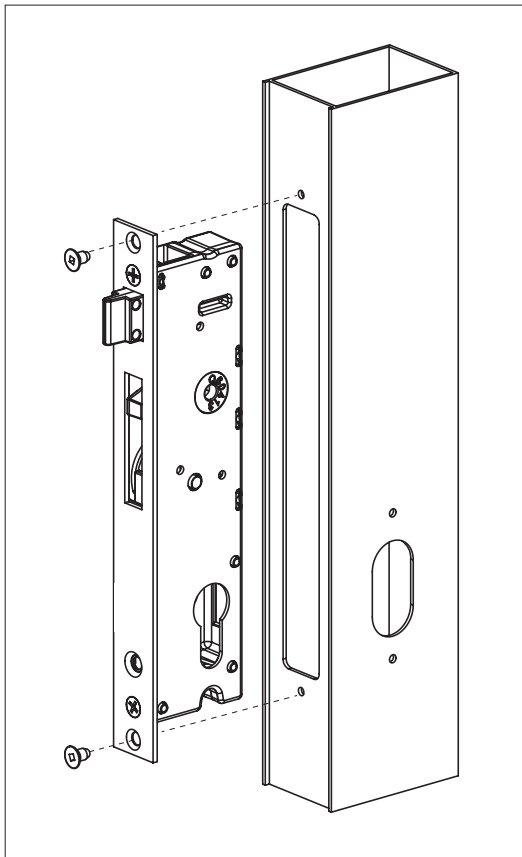

2. Fixing Lock

- Place the lock assembly into the stile
- Fix the lock onto the stile using the two 8g x 7.5mm screws

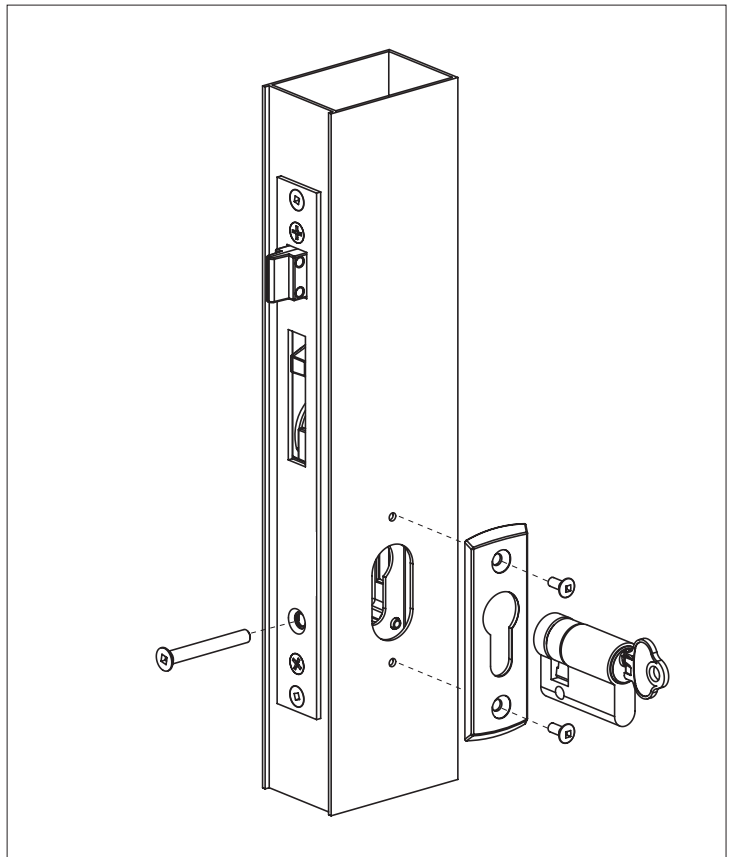

3. Fixing Furniture and Cylinder

- Insert cylinder into lockbody and fix with screw
- Fix internal escutcheon to stile using screws
- Fit external escutcheon to exterior of stile and fix using screws

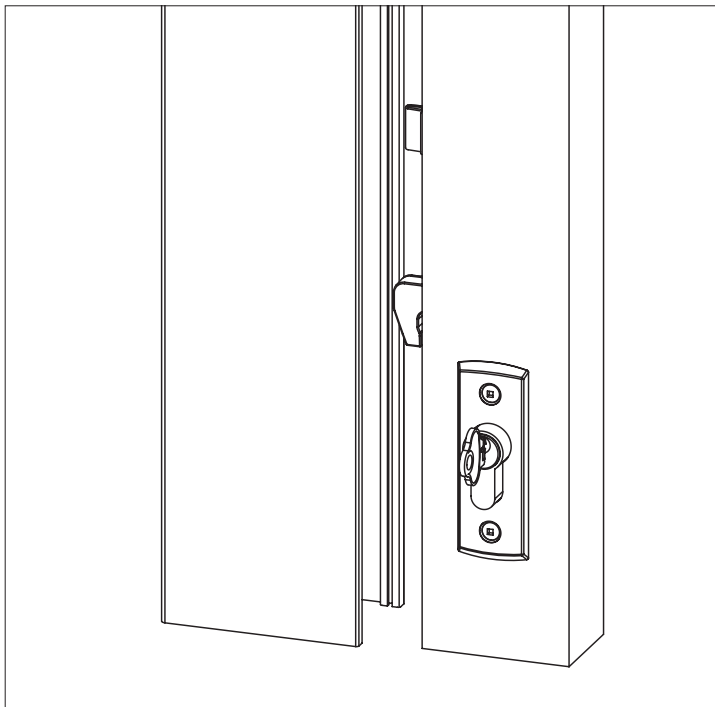

4. Positioning Strike

- Throw the bolt by depressing the anti-slam button and turning the key/knob
- Mark the door frame gently using a pencil, being careful not to scratch the finish on the joinery

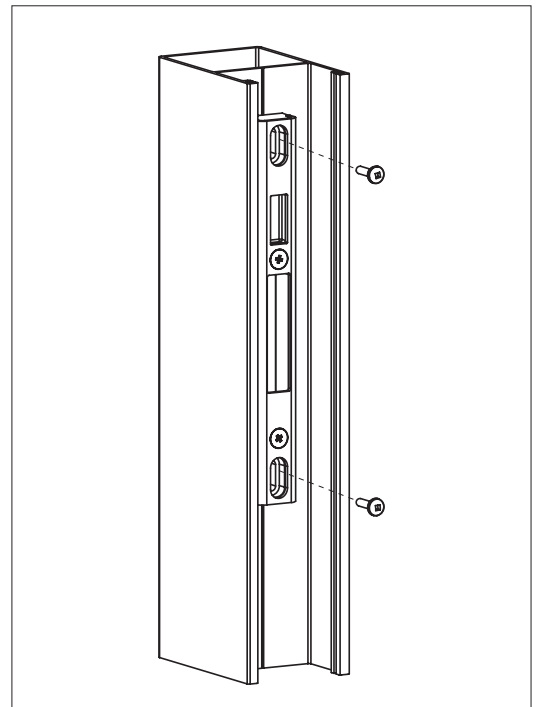

5. Fixing Strike

- Carefully align the strike so that the marks are inside the strike aperture
- Fix the strike to the frame
- For fine adjustment, the strike has slots and can be moved up or down slightly

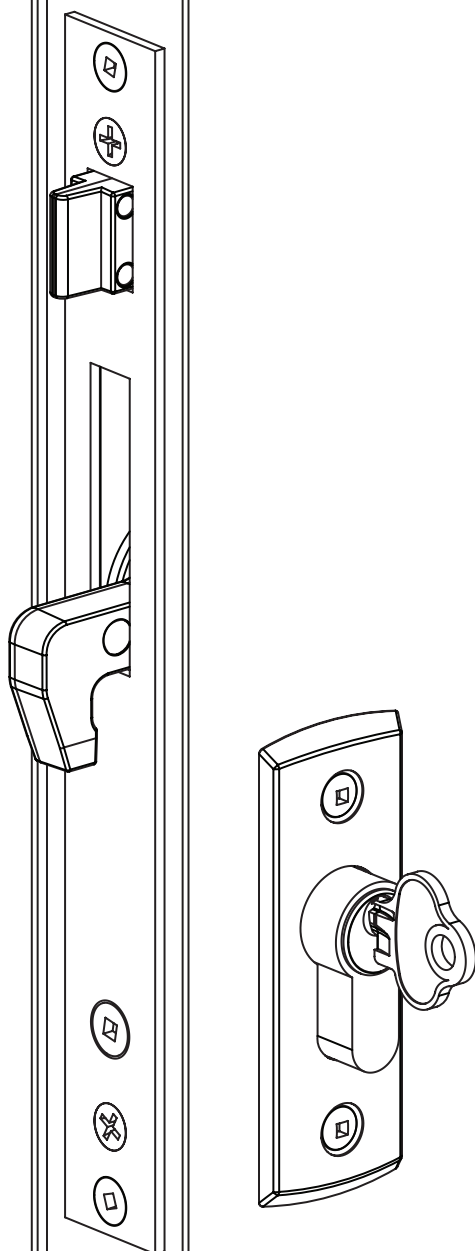

6. Lock operation

- Pull the door shut firmly
- Turn the key to operate the deadbolt and adjust strikes

Troubleshooting

Do I need to tap holes?	No. All screws are self tapping.
Do I have to use the supplied screws?	For best performance, it is recommended that only the supplied screws are used.
The key function does not operate	Ensure the lock is aligned correctly with the strike and the anti-slam is depressed when the door is closed.

WARRANTY

ASSA ABLOY New Zealand Ltd ("ASSA ABLOY") guarantees its products against defects in workmanship and materials.

If within 10 years of purchase a product is found to be defective, ASSA ABLOY will supply the same or equivalent product free of charge.

All electrical and electronic components used in ASSA ABLOY's range of products excluding batteries are guaranteed for a period of 12 months from the date of proof of purchase, unless stated otherwise.

ASSA ABLOY assumes no liability under the guarantee for the following:

1. Improper installation or failure to follow fitting instructions.
2. Failure due to improper maintenance.
3. Fair wear and tear.
4. Indirect or consequential loss or damage.
5. Cost of removal and/or replacement.
6. Cost of freight and/or travelling time.
7. Damage to or deterioration of plated finishes (soft finishes). As deterioration is possible under some environmental conditions, these finishes are excluded from this guarantee.
8. Any modification or repairs to a product, as supplied, unless authorised by ASSA ABLOY.
9. Use of replacement parts other than authorised parts.
10. Malfunction or failure of the product due to the use of non-genuine ASSA ABLOY parts.

Nothing in the ASSA ABLOY New Zealand Limited Warranty excludes, restricts or modifies any condition, warranty, right or liability implied or protected by law where to do so would render the Warranty, or any part of it, void.

10
YEAR
WARRANTY

