

HUSKY 120 PRO SOFT CLOSE HENDERSON

FITTING INSTRUCTIONS

HUSKY PRO KIT CONTENTS

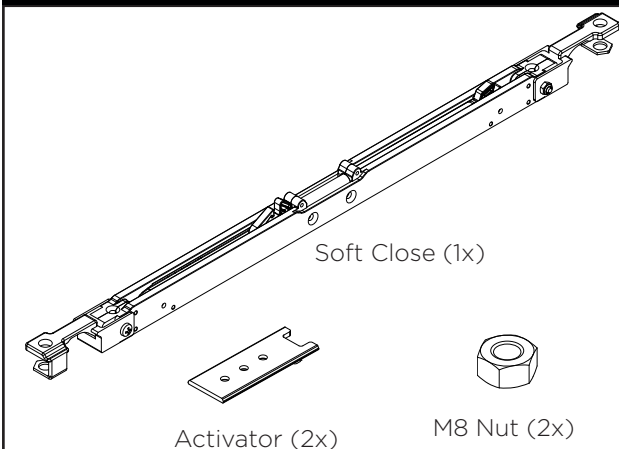

KIT AND DOOR SPECIFICATION

Kit Short Code

SOFTHP120



10 - 120kg

TOOLS REQUIRED

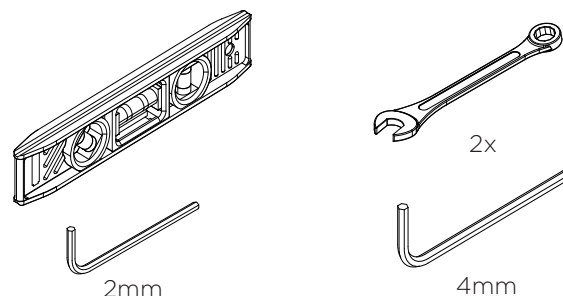

NOTE: IF RETRO-FITTING SOFT CLOSE TO PREVIOUSLY INSTALLED DOOR, START AT STEP 1. IF FITTING DURING INITIAL INTSTALLATION, START AT STEP 3.

1 LOOSEN NUTS AND REMOVE DOORS.

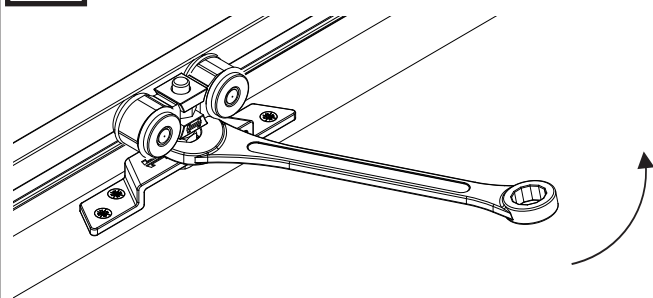

2 REMOVE COMPONENTS.

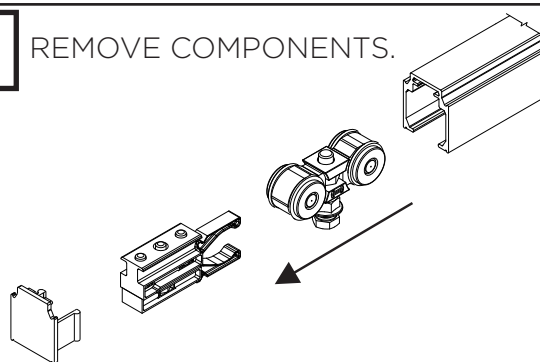

3 REPLACE LONGER NUT WITH M8 NUT SUPPLIED.

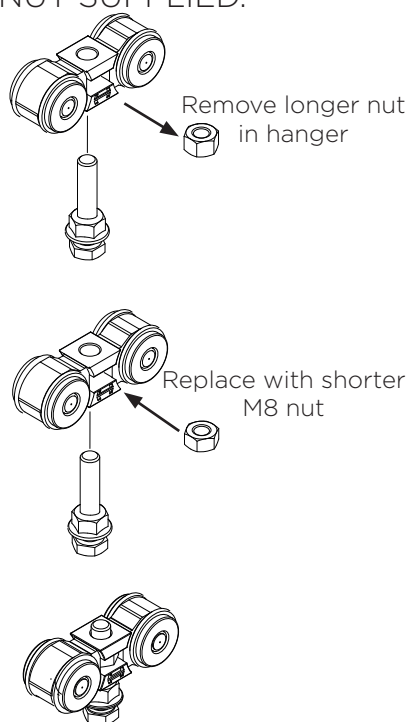

4 CONNECT SOFT CLOSE TO HANGER.

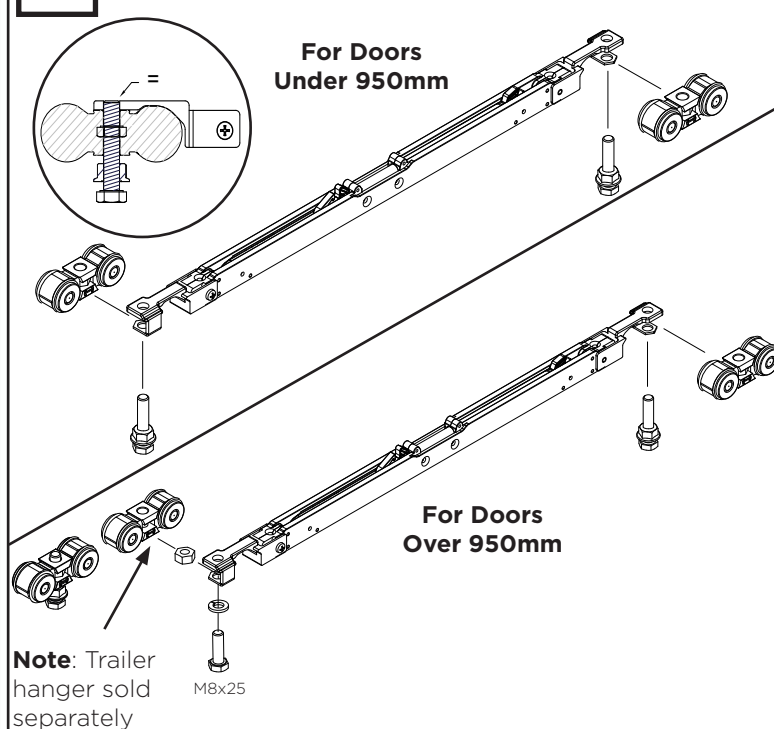

5 FIT APRON PLATES USING DOOR CENTRE LINE.

**For Doors
Under 950mm**

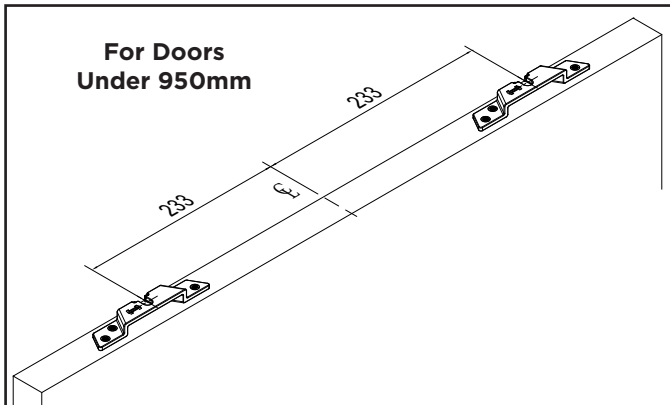

**For Doors
Over 950mm**

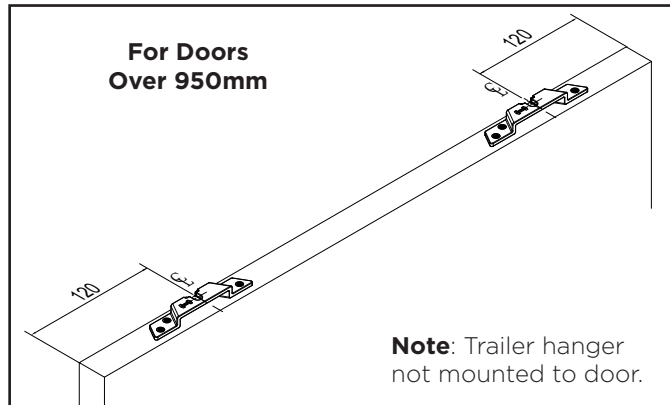

Note: Trailer hanger
not mounted to door.

6 POSITION INSIDE TRACK.

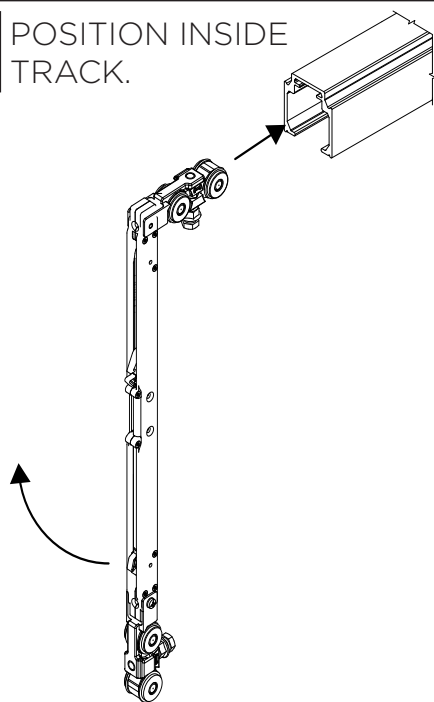

7 FIT HANGER TO APRON PLATE. ADJUST HEIGHT AND SECURE.

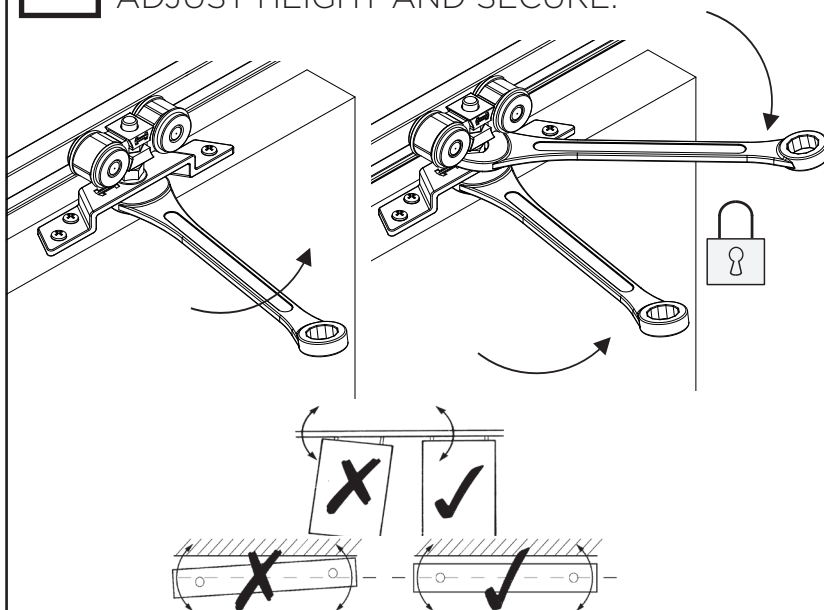

8 INSERT ACTIVATOR AND END CAPS.

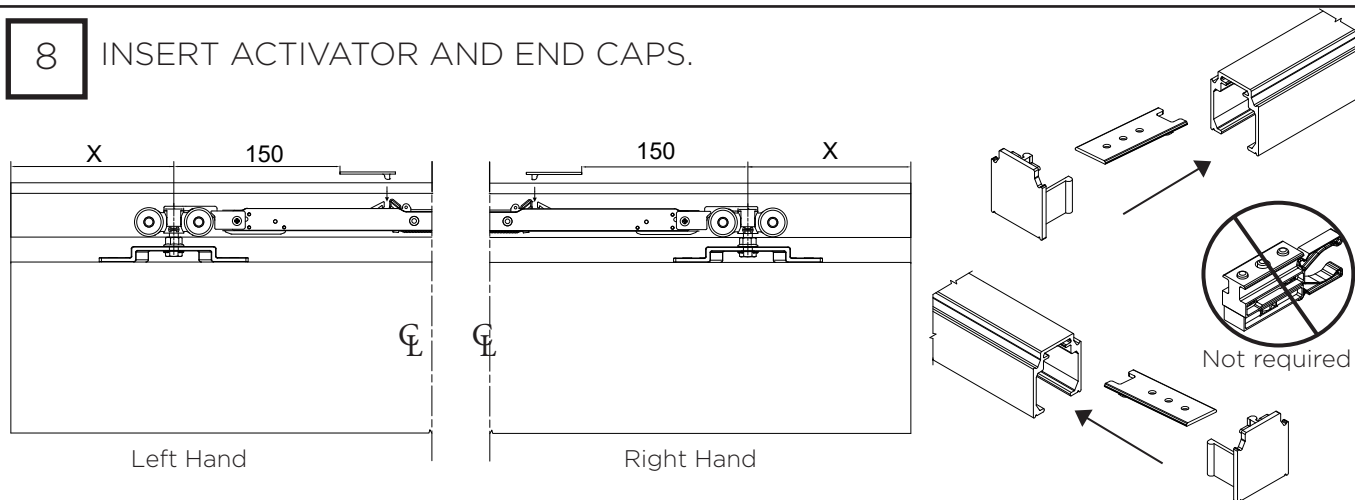

X = distance between edge of door in closed position to centre-line of apron plate.
X + 150 = Activator location

P C HENDERSON LTD

Durham Road, Bowburn,
Co. Durham,
DH6 5NG

UK SALES

t: +44 (0) 191 377 7345
e: sales@pchenderson.com
w: www.pchenderson.com

IRELAND SALES

t: +353 (0)1 643 6816
e: sales@pchenderson.ie
w: www.pchenderson.ie

INTERNATIONAL SALES

t: +44 (0) 191 377 7346
e: international@pchenderson.com
w: export.pchenderson.com

370771

REV 2

Oct-22