

1

Door Preparation

Drill holes to suit lever handle spindle and anchor nuts on the side where lever handle is required.

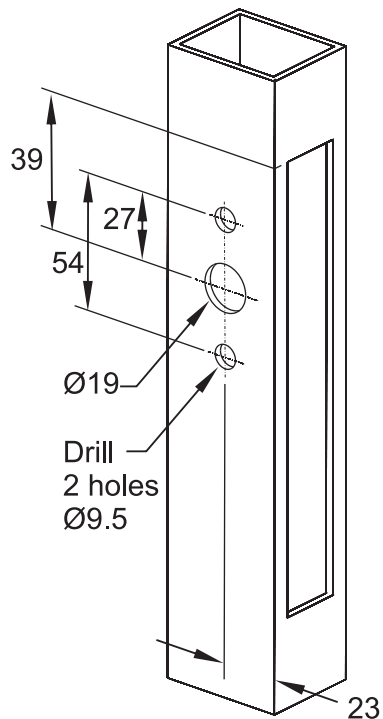

2

Fit Anchor Nuts

Screw 2 halves of anchor nuts together in 9.5mm holes, from each side of door sections, male nut to the outside. Ensure that top of nut is horizontal to enable lever escutcheon to fill over the top, tighten with a spanner.

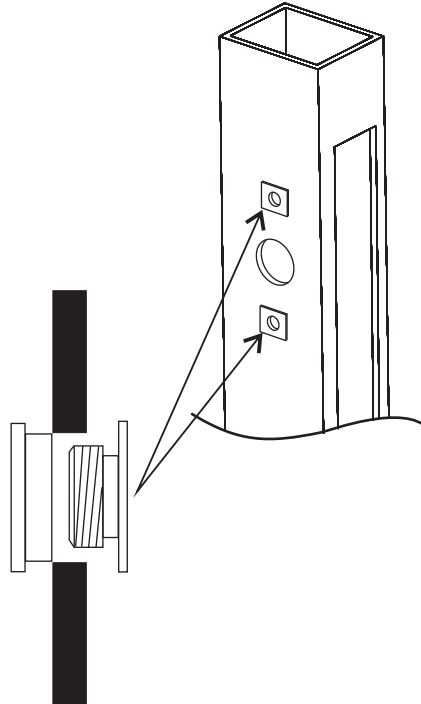

3

For Lever Handle Functions

Fit lever handle adaptor with bolt retracted. Assemble adaptor through cylinder hole in lock body on the side where lever is required. Engage turn knob gear with actuating lever gear as shown and secure adaptor with clamp screw. **Ensure clamp screw is fully inserted to firmly anchor adaptor.**

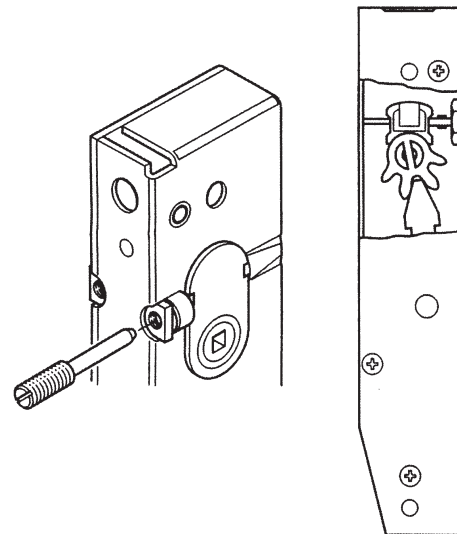

4

Assembly of Lever Handle

Fit lever handle assembly with bolt in the extended position. Fit spindle and spring with 7.6mm square into handle. Attach lever handle assembly with lever in the up position. Insert 5mm square into adaptor. Attach lever handle assembly with 2 countersunk head screws supplied.

